

Acetate Nose Pad

It is now possible to choose acetate color from our partner manufacturers, which will widen your color choice. We can provide the temple tip with the same color as the pad.



6 Standard Shapes

APS-01

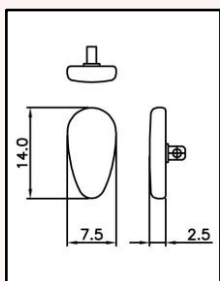

APS-02

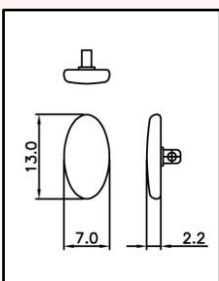

APS-03

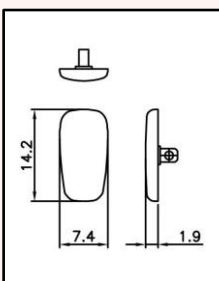

APS-05

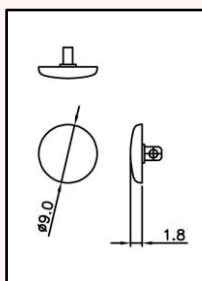

APS-07

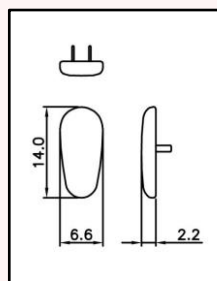

APS-08

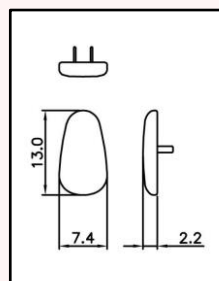

INTER EYES CO., LTD.

EURO VISION CO., LTD.



Nose pads fixing variation

GS: Screw version

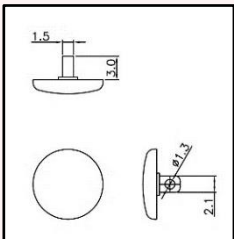

CO: Click-in version

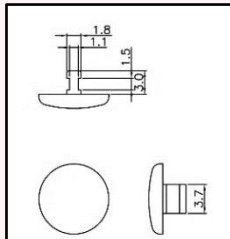

HU: HUG version

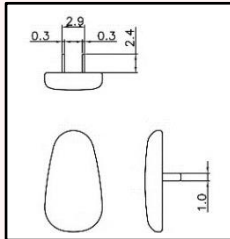

All 3 versions have Nylon inlay are glued on the acetate pad.

The glue complies with REACH regulations

Note: APS-05 is available only for Screw and Click-in versions. (HUG version is NOT available.)

Pad arm for HUG version

TPA-01NS Material: Nickel silver

TPA-01T Material: Titanium

TPA-05HUG Material: Titanium

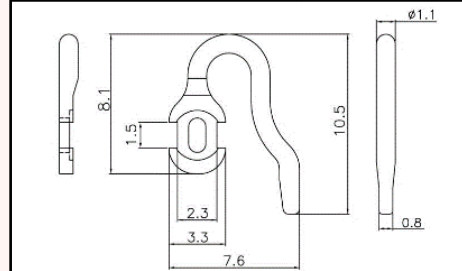
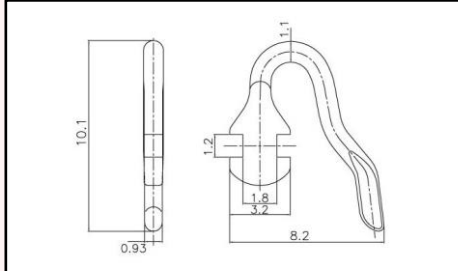
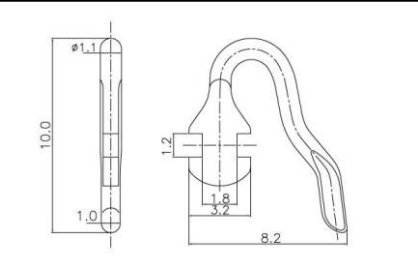

Temple tip

We can provide the temple tip with the same color as the pad.

EVS-101



EVS-103



EVS-105



EVS-106



EVS-107



EVS-207



EVS-301



	Length (mm)	Minimum Hole Diameter (+/-0.05mm)	Maximum Hole Diameter (+/-0.05mm)	Maximum Hole Size in Square Shape (mm)
EVS-101	72	1.0	2.0	1.2×2.6
EVS-103	70		1.6	1.2×2.6
EVS-105	72		1.5	1.2×1.9
EVS-106	70		1.5	1.2×2.1
EVS-107	70		1.6	1.2×2.3
EVS-207	70		1.4	1.2×1.6
EVS-301	69		1.5	1.2×1.4

Various Acetate Selections

All colors from our partner manufacturers are available. We will arrange the acetate orders directly.



金余(JINYU)

<http://www.jinyuplastic.com/Col/Col1/Index.aspx>



集美(JIMEI)

<https://www.jimei123.com/en/>



金亮(JINLIAN)

<http://jinliang.hk>